

Polypropylene

- Centre: Polypropylene.
- Tyre: N/app.
- Finish: Grey.



WED series

whl dia	tread width	load cap	bore dia	hub width	plain bore	roller bearing	ball bearing	used in castor series
					ref	ref	ref	
41	19	20	6.4	21	WED-158			LM
50	19	27	6.4	21	WED-234			LM
63	19	34	6.4	24	WED-2534			LM
75	25	60	8.4	27	WED-325			XL/XLF
100	25	75	8.4	27	WED-425			XL/XLF
	35	125	12	40	WED-41M12	WED-41RBM12		11/19
125	35	125	12	40	WED-51M12	WED-51RBM12		11/19, XL/XLF

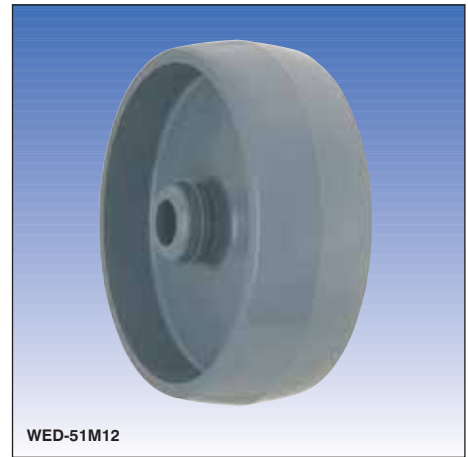

WED-51M12